

C 1000

Burnisher 16" - 1.000 rpm



High-performance polisher especially suited for maintenance cleaning of surfaces treated with metallic wax.

It allows to get a degree of high gloss and thanks to the spray electric system a “wet effect” in an incredibly easy and fast way. Thanks to its particular drive system it can be used in straight line and fan like action with consequent possibility to operate in small areas and to reach points normally not accessible by a common ultra high-speed unit. Power studied to get, with total adherence of the disc, fast departure sand a prolonged use. Electronic balancing of the rotor at full rating guarantees an operation without vibrations. Very strong induction motor for long lifetime and great performances. Safety switch with automatic motor stop as soon as the lever is not operated anymore. Ergonomic and comfortable handle, in highly resistant plastic material. All controls are contained in the impact resistant handle and can be put in action without moving the hands from working position.



Technical Data

Working width - Ø brush	mm	405
Brush speed	rpm	1000
Voltage	V	220 - 240
Frequency	Hz	50
Brush motor rating	W	1600
Brush contact pressure	g/cm²	43,2
Noise level	db(A)	<56
Transmission	Belt transmission	
IP code	IPX4	
Power supply cable	m	15
Weight (without accessories)	Kg	39
Dimensions	mm	1200x720x420

Optional Accessories

Type	Ref. No.
Spray electric system	00-356EL-GH
Gorilla disc 16" (x 5)	06-406-23

Product Identification

Type	Ref. No.	Pieces/pallet
C 1000	00-189BL	1

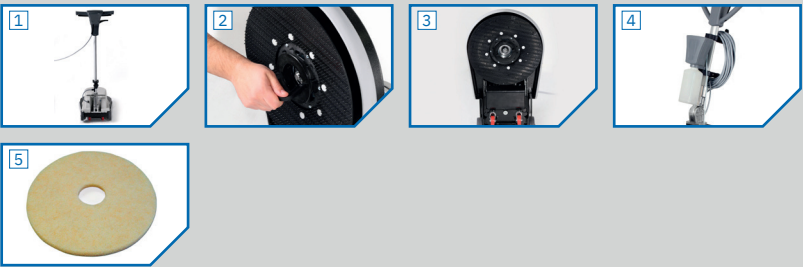

- 1 Slim size
- 2 “Center lock”, pad retaining system
- 3 Belt transmission
- 4 Spray electric system (optional)
- 5 Gorilla disc 16" (optional)